

With a private garden on the ground floor, an ideal investment

AED 945,981 - ID: I-S-R-JVC-OF-0417-02 - Jumeirah Village Circle Jumeirah Village Circle - Apartment



BUA 1,124 Sq Ft With a private garden on the ground floor, an ideal investment

Bedrooms	1
Bathrooms	2
Plot Size	1124 sq ft
Living Area	1124 sq ft
Parking	1
Available From	16-May-2017
Ensuite	1
Half Bath	1
Price/Area	842 sq ft
Posting Date	16/05/2017
View	Community

The perfect balance of residential community that meets your need and budget, located at the Al Hessa Street entrance of the community these apartments are in the perfect location. With easy access in and out the community, the residential complex is across the road from the only mall existing in JVC.

Affordable and convenient this community makes for the home that you want, getting a property. It is the exact kind of Dubai living that most people dream about in the region. Developed by Nakheel Properties, the Jumeirah Village is the ideal residence for people who love to work, play, and relax, all within just a few minutes from each other

Payment Plan:
35 % upto delivery
1.5% every month till 2021

Unit Features:
• BUA 1,124 Sq Ft
• Ceramic tiles

- 1 allocated parking space
- balcony
- Built in wardrobe
- Laundry room
- Powder room
- Private garden

Community Features:

- Children's play area outside
- Park
- Swimming pool
- Pets allowed
- Visitors parking

Please call us for exclusive viewing

056-2054400/04-3518133

Permit No. 4742

Property Gallery

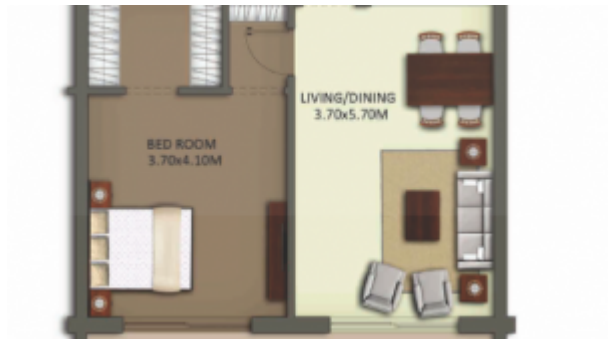

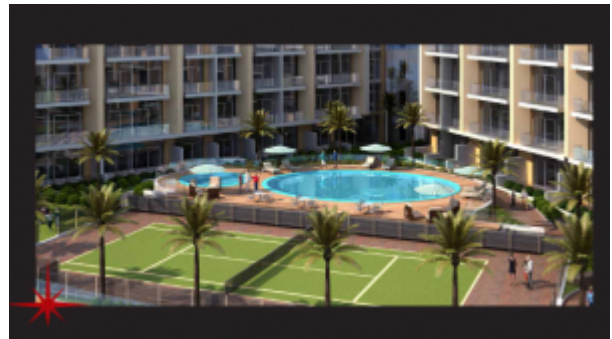

Property URL



<https://capellaproperties.ae/property/with-a-private-garden-on-the-ground-floor-an-ideal-investment-i-s-r-jvc-of-0417-02/>