

# Jumeirah Village circle, stunning studios with panoramic views for sale on a payment plan

Property is sold - ID: I-S-R-JVC-OF-0115-02 - Jumeirah Village Circle Jumeirah Village Circle - Apartment



Bedrooms	1
Bathrooms	1
Plot Size	527 sq ft
Living Area	527 sq ft
Parking	1
Built in	Off Plan (Q1 2017)
Available From	24-Jan-15
Price/Area	1024 sq ft
Posting Date	24/01/2015
View	Golf Course

**BUA 527Sq Ft – Jumeirah Village Circle, Stunning Studios with Panoramic Views for sale on a payment plan for sale on a very friendly Payment Plan, with initial down payment of only 10% (plus 4% Oqood charges)**

**1st Instalment on Initial deposit 10% on Booking + 4% for Oqood + ERES fees 1020/-**

**2nd Instalment, 5% on 10-June-2016**

**3rd Instalment, 5% on 10-September-2016**

**4th Instalment, 5% on 10-december-2016**

**5th Instalment, 5% on 10-March-2017**

**6th Instalment, 70% on handover Q1 of 2017**

This beautiful development is one of the very few high-rise developments with panoramic views of Jumeirah Village Circle and the stadium/golf course in Dubai sports city.

A community that embodies functional yet stylish lifestyle where the residents will enjoy a unique blend of relaxation, excitement and convenience through the many amenities on offer, whether it is shopping malls, food and beverage outlets,

international schools, hypermarkets, branded boutiques or public parks.

Located in Jumeirah Village circle, It is the best option for you. It is the exact kind of Dubai living that most people dream about in the region. Jumeirah Village is the ideal residence for people who love to work, play, and relax – all within just a few minutes from each other. With easy access to Sheikh Zayed Road, Al Maktoum International Airport, Sports City, Dubai International Airport is only 20 minutes away

For detailed virtual tours of properties in Dubai, visit [www.capellaproperties.ae](http://www.capellaproperties.ae)

**Unit features:**

- BUA 527 Sq feet
- 1 bathroom
- Built-in wardrobe
- Ceramic tiles
- Light fittings
- 1 allocated parking space in the basement

**Community features:**

- 24/7 Security
- Central A/C
- Common washroom
- 2 Swimming pool
- Children's swimming pool
- Children's playarea inside
- Children's playarea outside
- Pets allowed
- Firefighting system
- 2 gymnasium
- Leisure deck
- BBQ area
- Maintenance
- Prayers services
- Tennis court
- Visitors parking

**Please call us for exclusive viewing**

**056-2054400/04-3518133**

**Permit No. 18285**

## Property Gallery

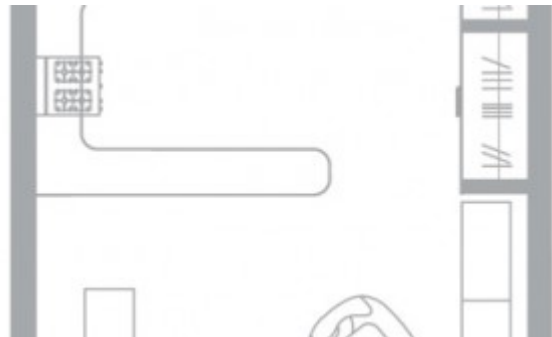



## Property URL



<https://capellaproperties.ae/property/jumeirah-village-circle-stunning-studios-with-panoramic-views-on-easy-payment-plan-2/>